

V-RING

40

Especificações Técnicas

40

Desenhos Técnicos

41

Tabelas V-Ring

V-RING

O V-Ring é uma vedação de uma peça única toda de borracha, a qual está montada sobre um eixo com dois lábios salientes e veda axialmente contra uma contraface, câmara de alojamento do selo, caso selo ou uma superfície similar. Funciona como uma vedação de lábios sem pressão em aplicações secas, prevenindo a entrada de sujeira, água, respingo de óleo e poeira entrem no sistema. Quando comparado com a maioria das vedações

radiais o V-Ring pode lidar com uma quantidade maior de excentricidade e desalinhamento retendo lubrificantes e excluindo contaminantes. Por isso, é usado principalmente em aplicações industriais para bombas, máquinas agrícolas, pontes rolantes, dispositivos de tratamento de madeira e metal, motores elétricos e máquinas de papel.

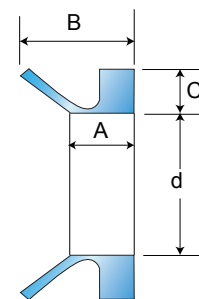
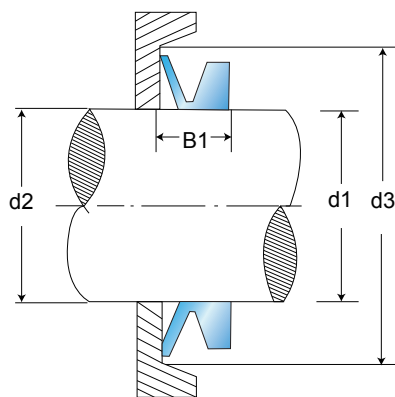

V-RING TIPO A

CÓDIGO	d1	d	c	A	B	d2	d3	B1
VA-003	2,7-3,5	2,50	1,50	2,0	3,0	d1+1	d1+4	2,5±0,3
VA-004	3,5-4,5	3,20	2,00	2,4	3,7	d1+1	d1+6	3,0±0,4
VA-005	4,5-5,5	4,00	2,00	2,4	3,7	d1+1	d1+6	3,0±0,4
VA-006	5,5-6,5	5,00	2,00	2,4	3,7	d1+1	d1+6	3,0±0,4
VA-007	6,5-8,0	6,00	2,00	2,4	3,7	d1+1	d1+6	3,0±0,4
VA-008	8,0-9,5	7,00	2,00	2,4	3,7	d1+1	d1+6	3,0±0,4
VA-010	9,5-11,5	9,00	3,00	3,4	5,5	d1+2	d1+9	4,5±0,6
VA-0012	11,5-13,5	10,50	3,00	3,4	5,5	d1+2	d1+9	4,5±0,6
VA-0013	13,5-15,5	11,70	3,00	3,4	5,5	d1+2	d1+9	4,5±0,6
VA-0014	15,5-17,5	12,50	3,00	3,4	5,5	d1+2	d1+9	4,5±0,6
VA-0016	15,5-17,5	14,00	3,00	3,4	5,5	d1+2	d1+9	4,5±0,6
VA-0018	17,5-19,0	16,00	3,00	3,4	5,5	d1+2	d1+9	4,5±0,6

V-RING TIPO A

CÓDIGO	d1	d	c	A	B	d2	d3	B1
VA-0020	19,0-21,0	18,00	4,00	4,7	7,5	d1+2	d1+12	6,0±0,8
VA-0022	21,0-24,0	20,00	4,00	4,7	7,5	d1+2	d1+12	6,0±0,8
VA-0025	24,0-27,0	22,00	4,00	4,7	7,5	d1+2	d1+12	6,0±0,8
VA-0028	27,0-29,0	25,00	4,00	4,7	7,5	d1+3	d1+12	6,0±0,8
VA-0030	29,0-31,0	27,00	4,00	4,7	7,5	d1+3	d1+12	6,0±0,8
VA-0032	31,0-33,0	29,00	4,00	4,7	7,5	d1+3	d1+12	6,0±0,8
VA-0035	33,0-36,0	31,00	4,00	4,7	7,5	d1+3	d1+12	6,0±0,8
VA-0038	36,0-38,0	34,00	4,00	4,7	7,5	d1+3	d1+12	6,0±0,8
VA-0040	38,0-43,0	36,00	5,50	5,5	9,0	d1+3	d1+15	7,0±1,0
VA-0045	43,0-48,0	40,00	5,00	5,5	9,0	d1+3	d1+15	7,0±1,0
VA-0050	48,0-53,0	45,00	5,00	5,5	9,0	d1+3	d1+15	7,0±1,0
VA-0055	53,0-58,0	49,00	5,00	5,5	9,0	d1+3	d1+15	7,0±1,0
VA-0060	58,0-63,0	54,00	5,00	5,5	9,0	d1+3	d1+15	7,0±1,0
VA-0065	63,0-68,0	58,00	5,00	5,5	9,0	d1+3	d1+15	7,0±1,0
VA-0070	68,0-73,0	63,00	6,00	6,8	11,0	d1+4	d1+18	9,0±1,2
VA-0075	73,0-78,0	67,00	6,00	6,8	11,0	d1+4	d1+18	9,0±1,2
VA-0080	78,0-83,0	72,00	6,00	6,8	11,0	d1+4	d1+18	9,0±1,2
VA-0085	83,0-88,0	76,00	6,00	6,8	11,0	d1+4	d1+18	9,0±1,2
VA-0090	88,0-93,0	81,00	6,00	6,8	11,0	d1+4	d1+18	9,0±1,2
VA-0095	93,0-98,0	85,00	6,00	6,8	11,0	d1+4	d1+18	9,0±1,2
VA-0100	98,0-105,0	90,00	6,00	6,8	11,0	d1+4	d1+18	9,0±1,2
VA-0110	105,0-115,0	99,00	7,00	7,9	12,8	d1+4	d1+21	10,5±1,5
VA-0120	115,0-125,0	108,00	7,00	7,9	12,8	d1+4	d1+21	10,5±1,5
VA-0130	125,0-135,0	117,00	7,00	7,9	12,8	d1+4	d1+21	10,5±1,5
VA-0140	135,0-145,0	126,00	7,00	7,9	12,8	d1+4	d1+21	10,5±1,5
VA-0150	145,0-155,0	135,00	7,00	7,9	12,8	d1+4	d1+21	10,5±1,5
VA-0160	155,0-165,0	144,00	8,00	9,0	14,5	d1+5	d1+24	12,0±1,8
VA-0170	165,0-175,0	153,00	8,00	9,0	14,5	d1+5	d1+24	12,0±1,8
VA-0180	175,0-185,0	162,00	8,00	9,0	14,5	d1+5	d1+24	12,0±1,8
VA-0190	185,0-195,0	171,00	8,00	9,0	14,5	d1+5	d1+24	12,0±1,8

V-RING TIPO A

CÓDIGO	d1	d	c	A	B	d2	d3	B1
VA-0199	195,0-210,0	180,00	8,00	9,0	14,5	d1+5	d1+24	12,0±1,8
VA-0200	190,0-210,0	180,00	15,00	14,0	25,0	d1+10	d1+45	20,0±4,0
VA-0220	210,0-235,0	198,00	15,00	14,0	25,0	d1+10	d1+45	20,0±4,0
VA-0250	235,0-265,0	225,00	15,00	14,0	25,0	d1+10	d1+45	20,0±4,0
VA-0275	265,0-290,0	247,00	15,00	14,0	25,0	d1+10	d1+45	20,0±4,0
VA-0300	290,0-310,0	270,00	15,00	14,0	25,0	d1+10	d1+45	20,0±4,0
VA-0325	310,0-335,0	292,00	15,00	14,0	25,0	d1+10	d1+45	20,0±4,0
VA-0350	335,0-365,0	315,00	15,00	14,0	25,0	d1+10	d1+45	20,0±4,0
VA-0375	365,0-390,0	337,00	15,00	14,0	25,0	d1+10	d1+45	20,0±4,0
VA-0400	390,0-430,0	360,00	15,00	14,0	25,0	d1+10	d1+45	20,0±4,0
VA-0450	430,0-480,0	405,00	15,00	14,0	25,0	d1+10	d1+45	20,0±4,0
VA-0500	480,0-530,0	450,00	15,00	14,0	25,0	d1+10	d1+45	20,0±4,0
VA-0550	530,0-580,0	495,00	15,00	14,0	25,0	d1+10	d1+45	20,0±4,0
VA-0600	580,0-630,0	540,00	15,00	14,0	25,0	d1+10	d1+45	20,0±4,0
VA-0650	630,0-665,0	600,00	15,00	14,0	25,0	d1+10	d1+45	20,0±4,0
VA-0700	665,0-705,0	630,00	15,00	14,0	25,0	d1+10	d1+45	20,0±4,0
VA-0725	705,0-745,0	670,00	15,00	14,0	25,0	d1+10	d1+45	20,0±4,0
VA-0750	745,0-785,0	705,00	15,00	14,0	25,0	d1+10	d1+45	20,0±4,0
VA-0800	785,0-830,0	745,00	15,00	14,0	25,0	d1+10	d1+45	20,0±4,0
VA-0850	830,0-875,0	785,00	15,00	14,0	25,0	d1+10	d1+45	20,0±4,0
VA-0900	875,0-920,0	825,00	15,00	14,0	25,0	d1+10	d1+45	20,0±4,0
VA-0950	920,0-965,0	865,00	15,00	14,0	25,0	d1+10	d1+45	20,0±4,0
VA-1000	965,0-1015,0	910,00	15,00	14,0	25,0	d1+10	d1+45	20,0±4,0
VA-1050	1015,0-1065,0	955,00	15,00	14,0	25,0	d1+10	d1+45	20,0±4,0
VA-1100	1065,0-1115,0	1000,00	15,00	14,0	25,0	d1+10	d1+45	20,0±4,0
VA-1150	1115,0-1165,0	1045,00	15,00	14,0	25,0	d1+10	d1+45	20,0±4,0
VA-1200	1165,0-1215,0	1090,00	15,00	14,0	25,0	d1+10	d1+45	20,0±4,0
VA-1250	1215,0-1270,0	1135,00	15,00	14,0	25,0	d1+10	d1+45	20,0±4,0
VA-1300	1270,0-1320,0	1180,00	15,00	14,0	25,0	d1+10	d1+45	20,0±4,0
VA-1350	1320,0-1370,0	1225,00	15,00	14,0	25,0	d1+10	d1+45	20,0±4,0

V-RING TIPO A

CÓDIGO	d1	d	c	A	B	d2	d3	B1
VA-1400	1370,0-1420,0	1270,00	15,00	14,0	25,0	d1+10	d1+45	20,0±4,0
VA-1450	1420,0-1470,0	1315,00	15,00	14,0	25,0	d1+10	d1+45	20,0±4,0
VA-1500	1470,0-1520,0	1360,00	15,00	14,0	25,0	d1+10	d1+45	20,0±4,0
VA-1550	1520,0-1570,0	1405,00	15,00	14,0	25,0	d1+10	d1+45	20,0±4,0
VA-1600	1570,0-1620,0	1450,00	15,00	14,0	25,0	d1+10	d1+45	20,0±4,0
VA-1650	1620,0-1670,0	1495,00	15,00	14,0	25,0	d1+10	d1+45	20,0±4,0
VA-1670	1670,0-1720,0	1540,00	15,00	14,0	25,0	d1+10	d1+45	20,0±4,0
VA-1750	1720,0-1770,0	1585,00	15,00	14,0	25,0	d1+10	d1+45	20,0±4,0
VA-1800	1770,0-1820,0	1630,00	15,00	14,0	25,0	d1+10	d1+45	20,0±4,0
VA-1850	1820,0-1870,0	1675,00	15,00	14,0	25,0	d1+10	d1+45	20,0±4,0
VA-1900	1870,0-1920,0	1720,00	15,00	14,0	25,0	d1+10	d1+45	20,0±4,0
VA-1950	1920,0-1970,0	1765,00	15,00	14,0	25,0	d1+10	d1+45	20,0±4,0
VA-2000	1970,0-2020,0	1810,00	15,00	14,0	25,0	d1+10	d1+45	20,0±4,0

V-RING TIPO S

CÓDIGO	d1	d	c	A	B	d2	d3	B1
VS-005	4,5-5,5	4,00	2,00	3,9	5,2	d1+1	d1+6	4,5±0,4
VS-006	5,5-6,5	5,00	2,00	3,9	5,2	d1+1	d1+6	4,5±0,4
VS-007	6,5-8,0	6,00	2,00	3,9	5,2	d1+1	d1+6	4,5±0,4
VS-008	8,0-9,5	7,00	2,00	3,9	5,2	d1+1	d1+6	4,5±0,4
VS-010	9,5-11,5	9,00	3,00	5,6	7,7	d1+2	d1+9	6,7±0,6
VS-012	11,5-13,5	10,50	3,00	5,6	7,7	d1+2	d1+9	6,7±0,6
VS-014	13,5-15,5	12,50	3,00	5,6	7,7	d1+2	d1+9	6,7±0,6
VS-016	15,5-17,5	14,00	3,00	5,6	7,7	d1+2	d1+9	6,7±0,6
VS-018	17,5-19,0	16,00	3,00	5,6	7,7	d1+2	d1+9	6,7±0,6
VS-020	19,0-21,0	18,00	4,00	7,9	10,5	d1+2	d1+12	9,0±0,8
VS-022	21,0-24,0	20,00	4,00	7,9	10,5	d1+2	d1+12	9,0±0,8
VS-025	24,0-27,0	22,00	4,00	7,9	10,5	d1+2	d1+12	9,0±0,8
VS-028	27,0-29,0	25,00	4,00	7,9	10,5	d1+3	d1+12	9,0±0,8
VS-030	29,0-31,0	27,00	4,00	7,9	10,5	d1+3	d1+12	9,0±0,8

V-RING TIPO S

CÓDIGO	d1	d	c	A	B	d2	d3	B1
VS-032	31,0-33,0	29,00	4,00	7,9	10,5	d1+3	d1+12	9,0±0,8
VS-035	33,0-36,0	31,00	4,00	7,9	10,5	d1+3	d1+12	9,0±0,8
VS-038	36,0-38,0	34,00	4,00	7,9	10,5	d1+3	d1+12	9,0±0,8
VS-040	38,0-43,0	36,00	5,00	9,5	13,0	d1+3	d1+15	11,0±1,0
VS-045	43,0-48,0	40,00	5,00	9,5	13,0	d1+3	d1+15	11,0±1,0
VS-050	48,0-53,0	45,00	5,00	9,5	13,0	d1+3	d1+15	11,0±1,0
VS-055	53,0-58,0	49,00	5,00	9,5	13,0	d1+3	d1+15	11,0±1,0
VS-060	58,0-63,0	54,00	5,00	9,5	13,0	d1+3	d1+15	11,0±1,0
VS-065	63,0-68,0	58,00	5,00	9,5	13,0	d1+3	d1+15	11,0±1,0
VS-070	68,0-73,0	63,00	6,00	11,3	15,5	d1+4	d1+18	13,5±1,2
VS-075	73,0-78,0	67,00	6,00	11,3	15,5	d1+4	d1+18	13,5±1,2
VS-080	78,0-83,0	72,00	6,00	11,3	15,5	d1+4	d1+18	13,5±1,2
VS-085	83,0-88,0	76,00	6,00	11,3	15,5	d1+4	d1+18	13,5±1,2
VS-090	88,0-93,0	81,00	6,00	11,3	15,5	d1+4	d1+18	13,5±1,2
VS-095	93,0-98,0	85,00	6,00	11,3	15,5	d1+4	d1+18	13,5±1,2
VS-100	98,0-105,0	90,00	6,00	11,3	15,5	d1+4	d1+18	13,5±1,2
VS-110	105,0-115,0	99,00	7,00	13,1	18,0	d1+4	d1+21	15,5±1,5
VS-120	115,0-125,0	108,00	7,00	13,1	18,0	d1+4	d1+21	15,5±1,5
VS-130	125,0-135,0	117,00	7,00	13,1	18,0	d1+4	d1+21	15,5±1,5
VS-140	135,0-145,0	126,00	7,00	13,1	18,0	d1+4	d1+21	15,5±1,5
VS-150	135,0-155,0	135,00	7,00	13,1	18,0	d1+4	d1+21	15,5±1,5
VS-160	155,0-165,0	144,00	8,00	15,0	20,5	d1+5	d1+24	18,0±1,8
VS-170	165,0-175,0	153,00	8,00	15,0	20,5	d1+5	d1+24	18,0±1,8
VS-180	175,0-185,0	162,00	8,00	15,0	20,5	d1+5	d1+24	18,0±1,8
VS-190	185,0-195,0	171,00	8,00	15,0	20,5	d1+5	d1+24	18,0±1,8
VS-199	195,0-210,0	180,00	8,00	15,0	20,5	d1+5	d1+24	18,0±1,8

V-RING TIPO L

CÓDIGO	d1	d	c	A	B	d2	d3	B1
VL-110	105,0-115,0	99,00	6,50	6,0	10,5	C+5	C+20	8,0±1,5
VL-120	115,0-125,0	108,00	6,50	6,0	10,5	C+5	C+20	8,0±1,5
VL-130	125,0-135,0	117,00	6,50	6,0	10,5	C+5	C+20	8,0±1,5
VL-140	135,0-145,0	126,00	6,50	6,0	10,5	C+5	C+20	8,0±1,5
VL-150	145,0-155,0	135,00	6,50	6,0	10,5	C+5	C+20	8,0±1,5
VL-160	155,0-165,0	144,00	6,50	6,0	10,5	C+5	C+20	8,0±1,5
VL-170	165,0-175,0	153,00	6,50	6,0	10,5	C+5	C+20	8,0±1,5
VL-180	175,0-185,0	162,00	6,50	6,0	10,5	C+5	C+20	8,0±1,5
VL-190	185,0-195,0	171,00	6,50	6,0	10,5	C+5	C+20	8,0±1,5
VL-200	195,0-210,0	182,00	6,50	6,0	10,5	C+5	C+20	8,0±1,5
VL-220	210,0-233,0	198,00	6,50	6,0	10,5	C+5	C+20	8,0±1,5
VL-250	233,0-260,0	225,00	6,50	6,0	10,5	C+5	C+20	8,0±1,5
VL-275	260,0-285,0	247,00	6,50	6,0	10,5	C+5	C+20	8,0±1,5
VL-300	285,0-310,0	270,00	6,50	6,0	10,5	C+5	C+20	8,0±1,5
VL-325	310,0-335,0	292,00	6,50	6,0	10,5	C+5	C+20	8,0±1,5
VL-350	335,0-365,0	315,00	6,50	6,0	10,5	C+5	C+20	8,0±1,5
VL-375	365,0-385,0	337,00	6,50	6,0	10,5	C+5	C+20	8,0±1,5
VL-400	385,0-410,0	360,00	6,50	6,0	10,5	C+5	C+20	8,0±1,5
VL-425	410,0-440,0	382,00	6,50	6,0	10,5	C+5	C+20	8,0±1,5
VL-450	440,0-480,0	405,00	6,50	6,0	10,5	C+5	C+20	8,0±1,5
VL-500	480,0-530,0	450,00	6,50	6,0	10,5	C+5	C+20	8,0±1,5
VL-525	510,0-540,0	472,00	6,50	6,0	10,5	C+5	C+20	8,0±1,5
VL-550	530,0-580,0	495,00	6,50	6,0	10,5	C+5	C+20	8,0±1,5
VL-600	580,0-630,0	540,00	6,50	6,0	10,5	C+5	C+20	8,0±1,5